

Características

- Diferentes tipos de accionamiento
- Tamaño muy compacto
- Libres de mantenimiento
- Especiales para tablero de control

Datos Técnicos

Fluido:
Aire comprimido Filtrado,
lubricado o no lubricado

Presión de Trabajo:
0 a 8 Bar ~ 0 a 114 PSI

Temperatura de Trabajo:
0°C a 60°C ~ 32°F a 140°F

Modelos Standard Regreso Resorte

| Referencia | NPT | Operador | CV | Color |
|------------|------|------------------------------------|------|----------|
| VM020112 | 1/8" | Botón Sobresaliente / Resorte - BS | 0.45 | Rojo |
| VM020113 | 1/8" | Botón Sobresaliente / Resorte - BS | 0.45 | Verde |
| VM020122 | 1/8" | Botón Rasante / Resorte - BR | 0.45 | Rojo |
| VM020123 | 1/8" | Botón Rasante / Resorte - BR | 0.45 | Verde |
| VM020144 | 1/8" | Rodillo Lateral - R | 0.45 | Metálico |
| VM020154 | 1/8" | Rodillo Escualizable - RE | 0.45 | Metálico |
| VM020164 | 1/8" | Rodillo Ajustable - RA | 0.34 | Metálico |
| VM020174 | 1/8" | Antena - A | 0.34 | Metálico |
| VM020212 | 1/4" | Botón Sobresaliente / Resorte - BS | 0.45 | Rojo |
| VM020213 | 1/4" | Botón Sobresaliente / Resorte - BS | 0.45 | Verde |
| VM020222 | 1/4" | Botón Rasante / Resorte - BR | 0.45 | Rojo |
| VM020223 | 1/4" | Botón Rasante / Resorte - BR | 0.45 | Verde |
| VM020244 | 1/4" | Rodillo Lateral - R | 0.45 | Metálico |
| VM020254 | 1/4" | Rodillo Escualizable - RE | 0.45 | Metálico |

Modelos Standard Dos Posiciones

| Referencia | NPT | Operador | CV | Color |
|------------|------|------------------------------|------|-------|
| VM030181 | 1/8" | Botón / Dos Posiciones - BP | 0.45 | Negro |
| VM030191 | 1/8" | Codillo / Dos Posiciones - C | 0.45 | Negro |
| VM0301912 | 1/8" | Parada de Emergencia - PE | 0.45 | Rojo |
| VM030281 | 1/4" | Botón / Dos Posiciones - BP | 0.45 | Negro |
| VM030291 | 1/4" | Codillo / Dos Posiciones - C | 0.45 | Negro |
| VM0302912 | 1/4" | Parada de Emergencia - PE | 0.45 | Rojo |

Materiales

- Cuerpo : Aluminio
- Carrete : Aluminio
- Sellos : NBR
- Operador : Plástico ABS
- Rodillo : Acero Niquelado

Dimensiones de la válvula

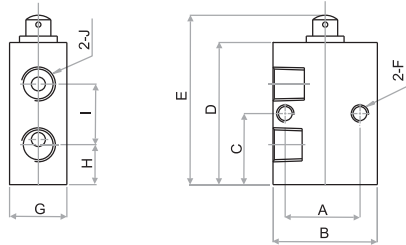

| NPT | A | B | C | D | E |
|------|----|----|------|----|----|
| 1/8" | 23 | 30 | 20,5 | 41 | 47 |
| 1/4" | 24 | 34 | 22,5 | 46 | 52 |

| NPT | F | G | H | I | J |
|------|--------|------|------|------|------|
| 1/8" | M5x0,8 | 16,5 | 11,5 | 17,5 | 1/8" |
| 1/4" | M5x0,8 | 17,5 | 12 | 21 | 1/4" |

Operadores Regreso Resorte

BS - Botón Sobresaliente

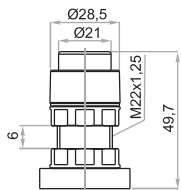
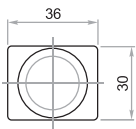

BS - Botón Rasante

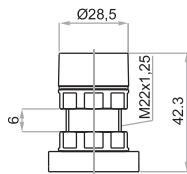
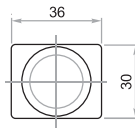

R - Rodillo Lateral

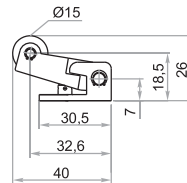
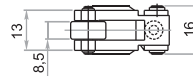

R - Rodillo Escualizable

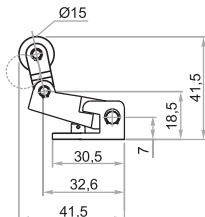
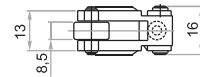

Operadores Dos Posiciones

BP - Botón

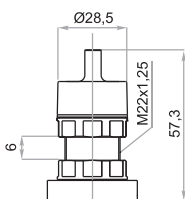
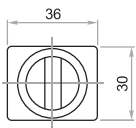

C - Codillo

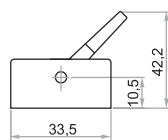
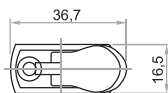

PE - Parada de Emergencia

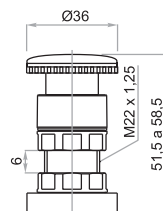
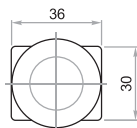

Válvulas de Rodillo Ajustable y Antena

